

MONTAGE HANDLEIDING

BRIXTON BQ-6345

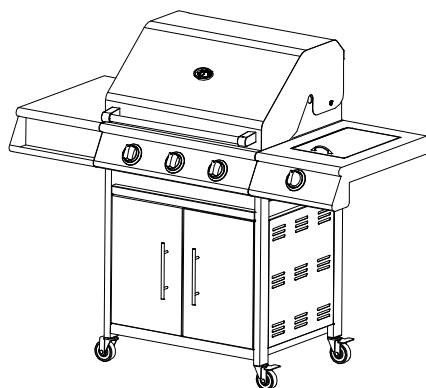

Voor vragen of onderdelen bel:

0900-5020043

info@liboairco.nl

LIBO Technical services
Stavangerweg 16a
9723 JC Groningen

This exploded perspective view illustrates the assembly of a laboratory instrument. The components are numbered as follows:

- 1**: Main housing or enclosure.
- 2**: A circular feature, possibly a lens or sensor, on the front of the housing.
- 3**: A small component, possibly a switch or connector, on the side of the housing.
- 4**: A cable or connector extending from the side of the housing.
- 5**: A rectangular component with a grid of slots, likely a filter or a sample tray.
- 6**: A long, thin component, possibly a filter or a sample tray.
- 7**: A long, thin component, possibly a filter or a sample tray.
- 8**: A long, thin component, possibly a filter or a sample tray.
- 9**: A rectangular component with a grid of slots, likely a filter or a sample tray.
- 10**: A rectangular component, possibly a filter or a sample tray.
- 11**: A rectangular component with three circular openings, possibly a filter or a sample tray.
- 12**: A small component, possibly a switch or connector.
- 13**: A rectangular component, possibly a filter or a sample tray.
- 14**: A rectangular component with a grid of slots, likely a filter or a sample tray.
- 15**: A rectangular component with a grid of slots, likely a filter or a sample tray.
- 16**: A rectangular component with a grid of slots, likely a filter or a sample tray.
- 17**: A vertical support structure.
- 18**: A vertical support structure.
- 19**: A rectangular component with a grid of slots, likely a filter or a sample tray.
- 20**: A vertical support structure.
- 21**: A base plate with a circular opening and a grid of slots.
- 22**: A vertical support structure.
- 23**: A vertical support structure.
- 24**: A vertical support structure.
- 25**: A horizontal support structure.
- 26**: A vertical support structure.
- 27**: A vertical support structure.
- 28**: A vertical support structure.
- 29**: A vertical support structure.
- 30**: A rectangular component with a grid of slots, likely a filter or a sample tray.
- 31**: A rectangular component with a grid of slots, likely a filter or a sample tray.
- 32**: A rectangular component with a grid of slots, likely a filter or a sample tray.
- 33**: A small component, possibly a switch or connector.
- 34**: A small component, possibly a switch or connector.
- 35**: A rectangular component with a grid of slots, likely a filter or a sample tray.
- 36**: A rectangular component with a grid of slots, likely a filter or a sample tray.
- 37**: A rectangular component with a grid of slots, likely a filter or a sample tray.
- 38**: A rectangular component with a grid of slots, likely a filter or a sample tray.
- 39**: A rectangular component with a grid of slots, likely a filter or a sample tray.
- 40**: A small component, possibly a switch or connector.

ONDERDELENLIJST

REF#	OMSCHRIJVING	Q'TY	REF#	OMSCHRIJVING	Q'TY
1	PANEEL LINKS DEKSEL	1	28	KRANENGEDEELTE	1
2	TEMPERATUUR METER	1	29	SLANG	1
3	HOUDER HANDGREEP	2	30	ZIJKRAAN	1
4	HANDGREEP DEKSEL	1	31	ACHTERPANEEL	1
5	GRILLROOSTERS	2	32	RECHTERBLAD	1
6	VLAMVERDELERS	3	33	ZIJBRANDER	1
7	HOOFDBRANDERS	3	34	RING ZIJBRANDER	1
8	WARMHOUD ROOSTERS	1	35	GRILLROOSTER	1
9	VUURBAK	1	36	DEKSEL ZIJBANDER	1
10	LINKER BLAD	1	37	SCHARNIER DEKSEL	1
11	BEDIENINGSPANEEL	1	38	LEKBAK GREEP L64	1
12	KNOPPEN	4	39	ACHTER VENTILATIE PANEEL	1
13	LEKBAK	1	40	DRAAIPIN DEKSEL	2
14	LEKBAK HANDGREEP L96	1	41		
15	HANDGREEP DEUR	2	42		
16	DEUR	2	43		
17	DEURSCHARNIER	2	44		
18	ZWENKWIELEN	2	45		
19	ACHTERPANEEL	2	46		
20	LINKER VOORPOOT	1	47		
21	ONDERBLAD	1	48		
22	ZWENKWIEL MET REM	2	49		
23	RECHTER ACHTERPOOT	1	50		
24	RECHTER VOORPOOT	1	51		
25	DEUR	2	52		
26	LINKER ACHTERPOOT	1	53		
27	REGELAAR	1	54		

Stap 1:

Verbind de linker voor en achterpoot d.m.v. de steunbalk. Monteer daarna het linker zijpaneel tussen de poten. Doe hetzelfde voor de rechter poten.

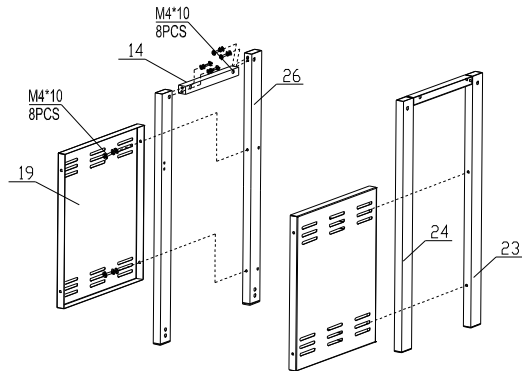

Stap 2:

Monteer de poten aan het onder paneel.

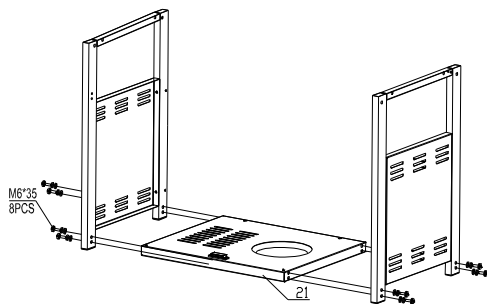

Stap 3:

Monteer het achterpaneel tussen de beide achterpoten

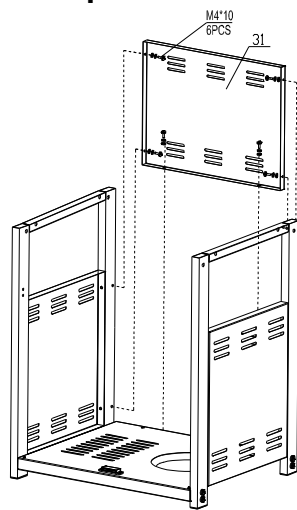

Stap 4:

Monteer de vier zwenkwielen.

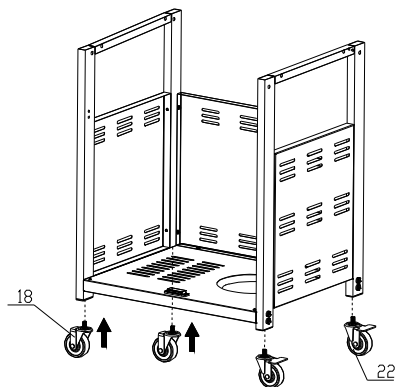

Stap 5:

Installeer de twee deuren zoals aangegeven op de tekening.

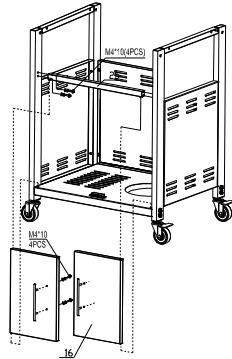

Stap 6:

Zet de complete vuurbak op het cabinet en zet deze vast met de vier schroeven.

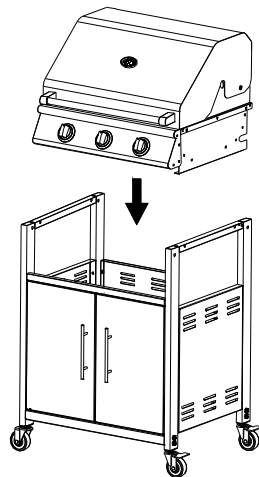

Stap 7:

Monteer nu het linker zijpaneel en de rechter zijbrander aan de vuurbak.

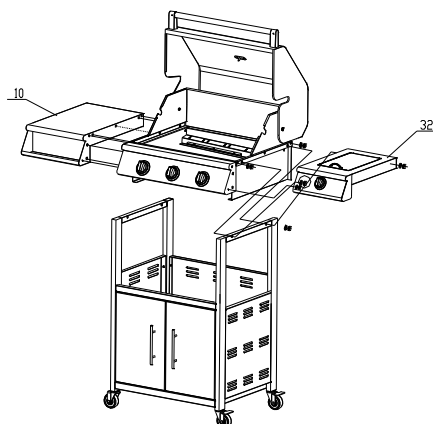

Stap 8:

Plaats nu de vlamverdelers, de grill platen en het warmhoudrek in de vuurbak.



**Zorg dat de gasslangen goed en vast zijn gemonteerd.
Uw BBQ is klaar voor gebruik.**

Voor de ingebruikname en de veiligheidsinstructies dient u de bijgesloten handleiding te raadplegen.